

NOVA LUCE

9030875

PART A

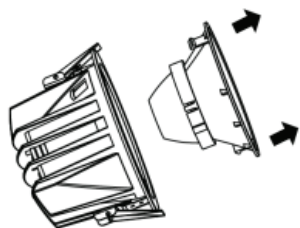

1. Remove the reflector

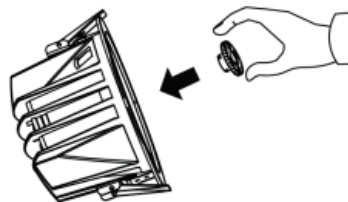

2. Insert the bulb

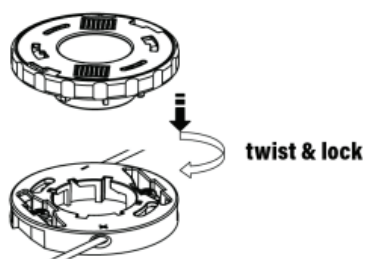

2.a. For the installation of the bulb to be correct, first twist & lock into place

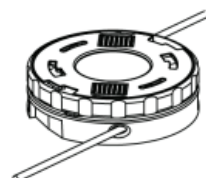

2.b. Then proceed into insertion

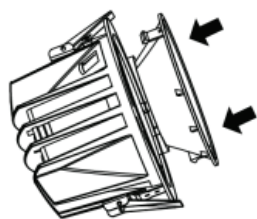

5. Apply the reflector



6. Ready to install
& proceed to Part B

NOVA LUCE

9030875

PART B

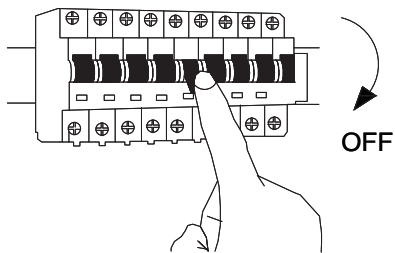

1. Turn off the general Switch

Ø210		Ø195	▲ A 121mm	max.900mA
Ø155		Ø145	▲ A 110mm	max. 900mA
Ø125		Ø115	▲ A 90mm	max. 700mA
Ø105		Ø95	▲ A 80mm	max. 500mA



2. Create a CutOut

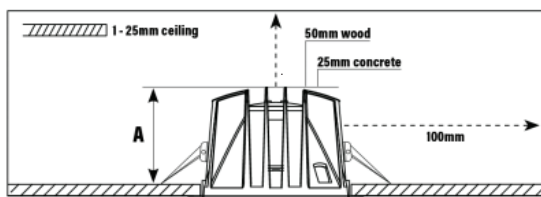

3. Take into consideration the material you are opening the hole

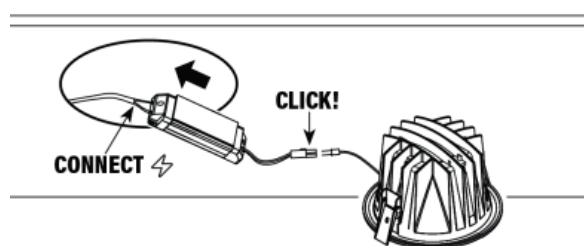

4. Plug in the wires

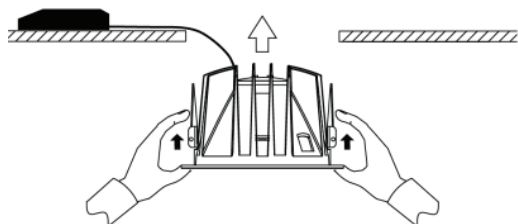

5. Insert the luminaire into the opening



6. Make it steady by fixing it onto place

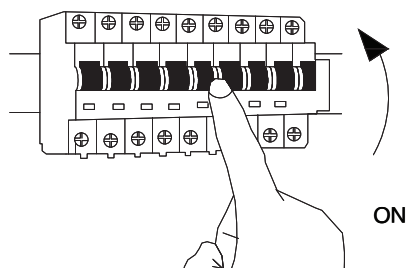

7. Turn on the general Switch

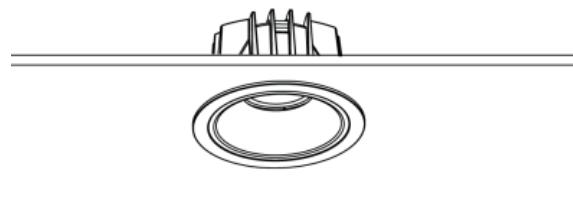

WARNING: The luminaire is not suitable for covering with thermally insulating material

