

1

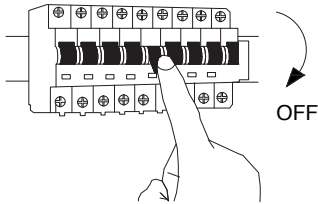

Turn off the general switch

2

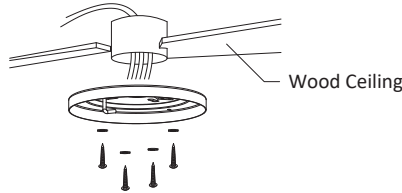

For Wood: Apply screws
With washer

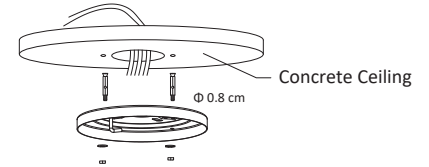

For Concrete: Drill holes D: 0.8 cm
Apply anchors with screws

3

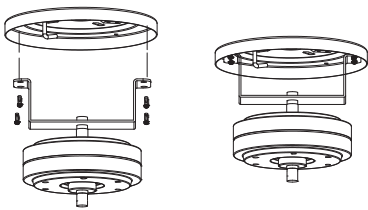

Apply the element in to place
With screws

4

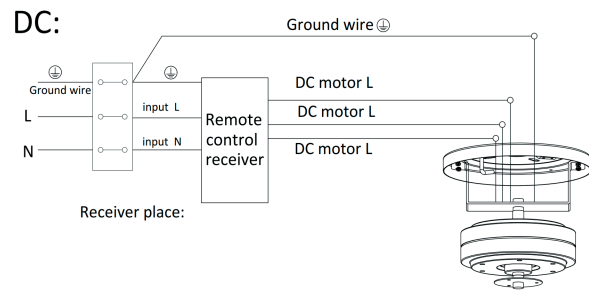

Connect wires

5

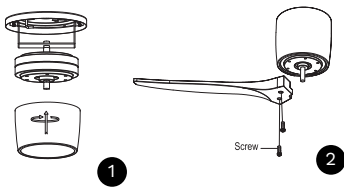

Apply the element with blades

6

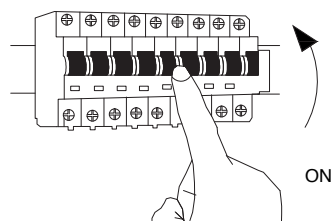

Turn on the general switch

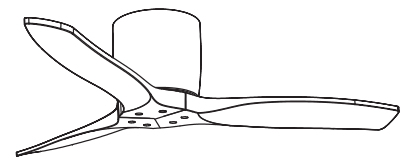

Important Safety Instructions

- Use only genuine Ruixuan replacement parts.
- Securely mount the fan to the building's structural support using provided hardware.
- Disconnect power at the circuit breaker before installation to prevent electrical shock.
- Ensure all wiring complies with national and local electrical codes (ANSI/NFPA 70). Consult a licensed electrician if needed.
- Avoid bending blade attachments or inserting objects into moving blades.
- Do not use solid-state speed controls. Use only approved speed control devices.
- Maintain caution and sound judgment during installation and operation.