

NOVA LUCE

9011520, 9011521,
9011522, 9011523

1

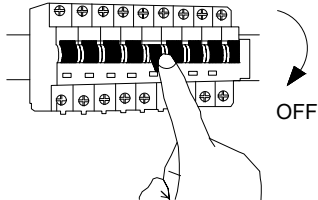

Turn off the general switch

2

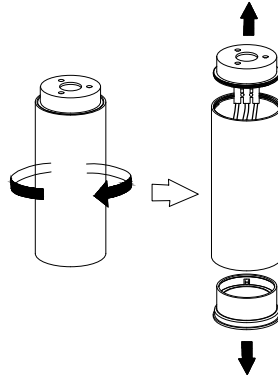

Dismantle parts

3

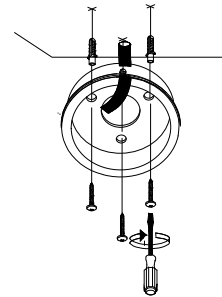

Mark & drill holes,
apply plastic anchors
& tie up screws

4

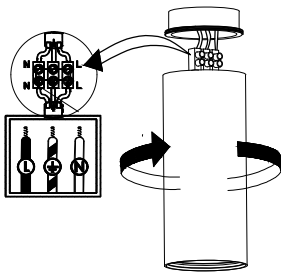

Connect wires
& assemble parts into place by rotate

5

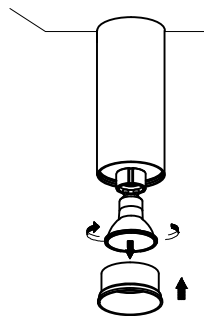

Fix it place
& apply the bulb
& the lid by rotate

6

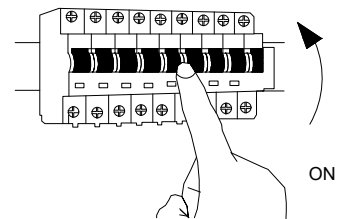

Turn on the general switch

7

