

# NOVA LUCE

9011518, 9011519

1

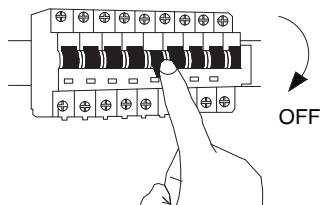

Turn off the general switch

2

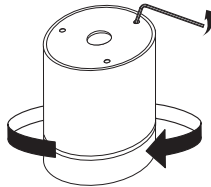

Dismantle parts

3



Separate the parts

4

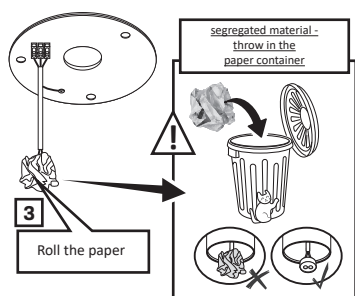

Recycle the material

5

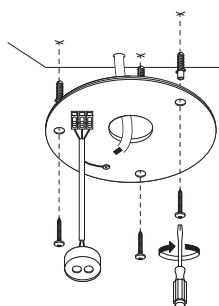

Mark & drill holes  
Apply plastic anchors & tie up screws

6

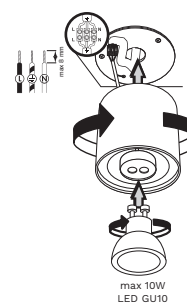

Connect wires  
& apply the bulb into place

7

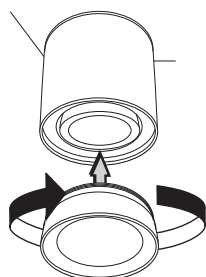

Apply the cap into place  
by rotate

8

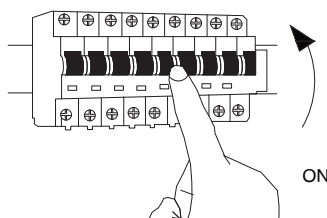

Turn on the general switch

9

