

# NOVA LUCE

## Parts Included

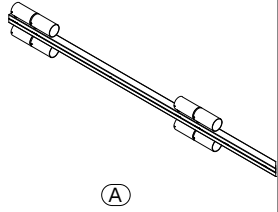

6X		(B)
6X		(C)
1X		(D)
4X		(E)
1X		(F)

## Tools

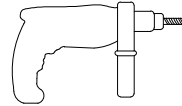
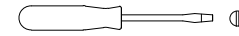
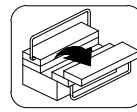

1

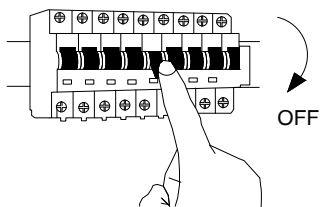

Turn off the General Switch

2

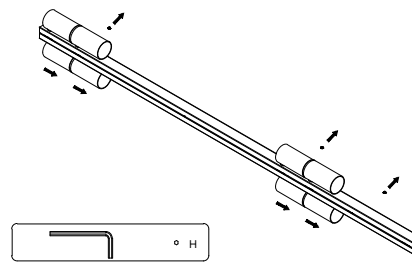

Untie side screws  
& secure canopies into steady position

3

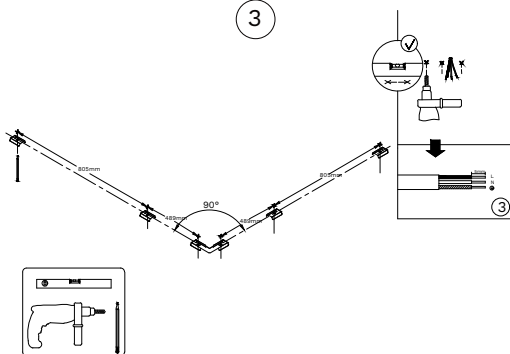

Mark and drill holes & prepare wires

4

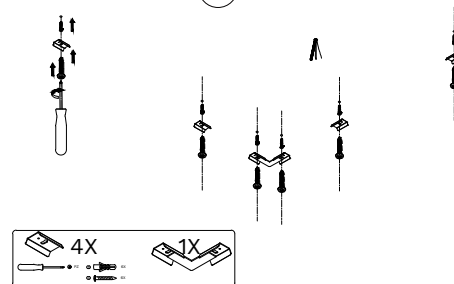

Apply anchors & tie up screws  
to install the base on the ceiling

5

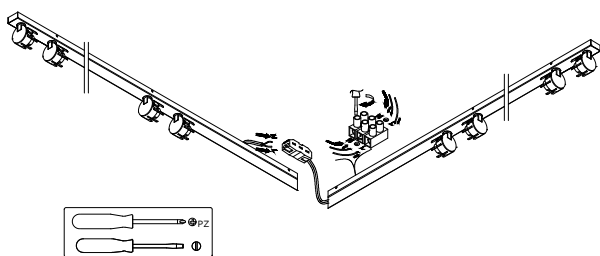

Connect wires

6

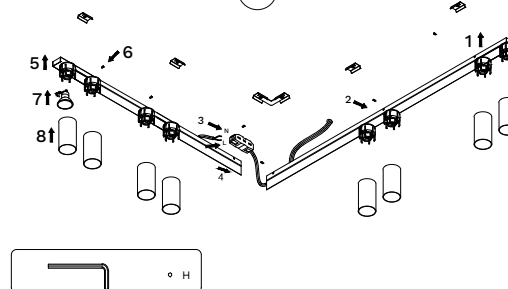

Fix base into place, apply side screws,  
insert the bulbs by rotating & tie up the caps



# NOVA LUCE

9030918/ 9030919

7

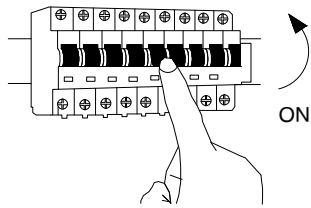

Turn on the General Switch

8

